

# Silicon Carbide | HVAC

Hot Surface Ignitors

Robertshaw



41-403

## Description

Robertshaw® silicon carbide hot surface ignitors are a reliable solution constructed of a material proven to deliver predictable ignition and lengthy service. They feature 18-gauge nickel chrome lead wires enclosed in high-temperature fiberglass insulation.

- Wide selection for nearly any HVAC system configuration
- Reliable:
- High-purity Crystar™ recrystallized silicon carbide
- High physical and thermal strength, and electrical stability
- Reach ignition temperatures in 17 seconds

## Features and Benefits

- Wide selection for nearly any HVAC system configuration
- High-purity Crystar™ recrystallized silicon carbide
- Reach ignition temperatures in 17 seconds

## Applications

- Furnaces
- Boilers
- Rooftop heaters
- Infrared burners
- Unit heaters
- Water heaters

**3** Year  
Limited  
Warranty

Robertshaw  
RANCO • PARAGON • CASTFUTURA

**Customer Service**  
+1 800 304 6563  
HVACCustomerService  
@robertshaw.com

**Technical Service**  
+1 800 445 8299  
TechnicalService  
@robertshaw.com

[www.robertshaw.com](http://www.robertshaw.com)  
©2024 Robertshaw  
05/24 150-2844 RevB

# Specifications

Silicon Carbide - Hot Surface Ignitor

- Operating voltage - 120V AC (including 208/240V rated models)
- Lead wire temperature rating - 392°F / 200°C
- Wire gauge - 18 AWG

Part Number	Operating Voltage	Ceramic Block Style	Wire Gauge	Lead Wire Length	Lead Wire Temperature Rating	Connector Type	Terminal Connector Type	Included Hardware
41-401	120V AC	A	18 AWG	5½ in. (139.7 mm)	392°F / 200°C	Molex internally keyed connector with .084 pins	A	Gasket
41-402	120V AC	B	18 AWG	19 <sup>1</sup> / <sub>8</sub> in. (485.8 mm)	392°F / 200°C	Stripped ends	None	None
41-403	120V AC	C	18 AWG	5¼ in. (133.35 mm)	392°F / 200°C	Stripped ends	None	None
41-404	120V AC	C	18 AWG	4½ in. (114 mm)	392°F / 200°C	Receptacle with .093 in. male pins	D	Special mounting adaptors
41-405	120V AC	D	18 AWG	5¼ in. (133.35 mm)	392°F / 200°C	Stripped ends	None	None
41-406	120V AC	E	18 AWG	11 in. (279.4 mm)	392°F / 200°C	Stripped ends	None	None
41-407	120V AC	C	18 AWG	4½ in. (114 mm)	392°F / 200°C	Molex front lock connector with .092 male pins	B	None
41-408	120V AC	B	18 AWG	5¼ in. (133.35 mm)	392°F / 200°C	Molex side lock connector with .092 male pins	C	None
41-409	120V AC	C	18 AWG	5¼ in. (133.35 mm)	392°F / 200°C	Receptacle with .093 in. male pins	D	None
41-410	120V AC	B	18 AWG	5¼ in. (133.35 mm)	392°F / 200°C	Molex front lock connector	B	None
41-411	120V AC	B	18 AWG	4½ in. (114 mm)	392°F / 200°C	Molex side lock connector	C	None
41-412	120V AC	F	18 AWG	5¼ in. (121 mm)	392°F / 200°C	Receptacle with .093 in. male pins	D	None
41-413	120V AC	2 in. (51 mm) L x 1 <sup>3</sup> / <sub>8</sub> in. (16 mm) dia	18 AWG	1 <sup>3</sup> / <sub>8</sub> in. (16 mm)	392°F / 200°C	¼ in. female QC terminals	¼ in. (6 mm) Q.C.	None
41-414	120V AC	F	18 AWG	5¼ in. (133 mm)	392°F / 200°C	Receptacle with .093 in. male pins	D	Special mounting adaptors
41-418	120V AC	B	18 AWG	5¼ in. (133 mm)	392°F / 200°C	Molex side lock connector	C	Bracket
41-419	120V AC	G	18 AWG	5 in. (127 mm)	392°F / 200°C	Receptacle with .093 in. male pins	D	None

Ceramic Block Styles

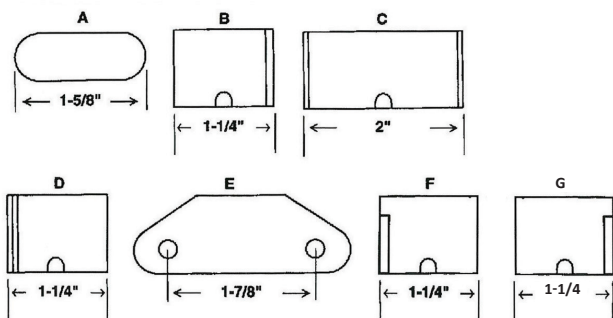

Terminal Block Styles

